



Crown Street, Brandon, Suffolk, IP27 0JR
Rent - £1,450 PCM Deposit - £1,673

A deceptively spacious detached bungalow is located close to RAF bases. The property offers four bedrooms, two bathrooms, lounge, dining area and kitchen. Outside there is a driveway for two cars and an enclosed rear garden.

- DETACHED BUNGALOW
- FOUR BEDROOMS
- SPACIOUS LOUNGE
- FAMILY BATHROOM & ENSUITE
- OFF ROAD PARKING & GARDEN
- CLOSE TO RAF BASES
- GAS HEATING & ENERGY RATING - D
- APPROXIMATE SIZE - 1141 SQ FT
- COUNCIL TAX BAND - D
- AVAILABLE BEGINNING OF JULY



Council Tax Band: D - EPC Rating: D 65

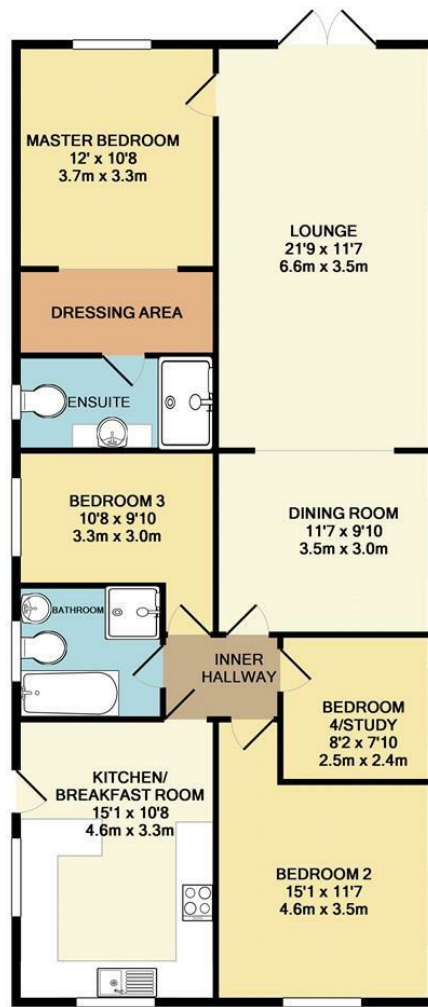

TOTAL APPROX. FLOOR AREA 1141 SQ.FT. (106.0 SQ.M.)

Whilst every attempt has been made to ensure the accuracy of the floor plan contained here, measurements of doors, windows, rooms and any other items are approximate and no responsibility is taken for any error, omission, or mis-statement. This plan is for illustrative purposes only and should be used as such by any prospective purchaser. The services, systems and appliances shown have not been tested and no guarantee as to their operability or efficiency can be given.
 Made with Metropix ©2016

